



SERVICE PARTS LIST

BUL. 54-08-9012

1/4" ELECTRIC DRILL

REVISED BUL
6148-3

DATE
FEB. '68

Catalog No. 0600-8

Starting
Serial No. 148-2530

WIRING INSTR.

Both Model and Serial No. must be furnished to obtain correct parts.

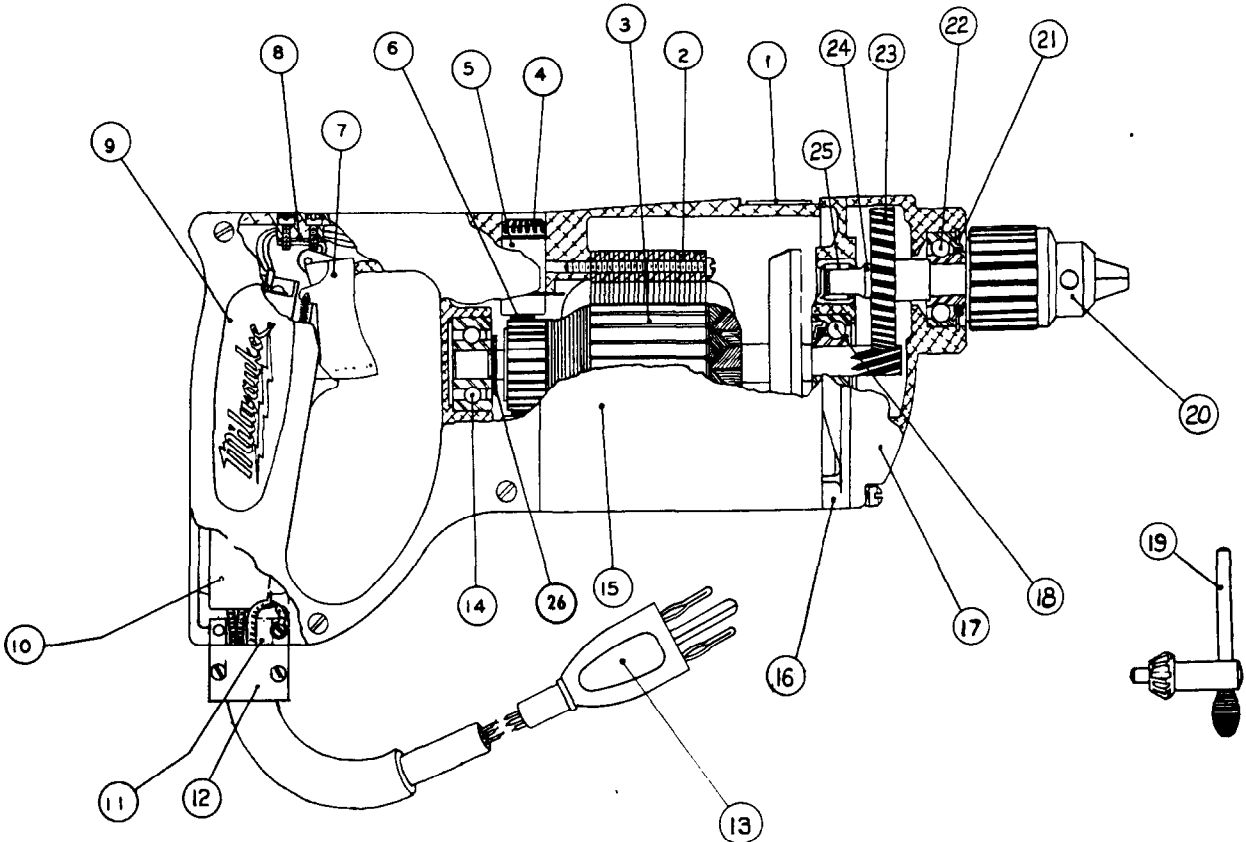

ILLUSTRATED PARTS

FIG.	PART NO.	DESCRIPTION OF PART	FIG.	PART NO.	DESCRIPTION OF PART
★1	12-15-5250	Name Plate	14	02-04-0970	Ball Bearing
★2	18-42-1040	Field Assembly	15	28-50-4484	Motor Housing
★3	16-42-1300	Armature Assembly	16	28-28-0821	Diaphragm
4	23-44-0060	Carbon Brush Ret. Screw (2)	17	28-14-0841	Gear Case
5	22-22-0080	Brush Holder Assembly (2)	18	02-04-0970	Ball Bearing
6	22-18-0100	Carbon Brush Assemblies (2)	19	48-66-3200	Chuck Key
7	23-66-0230	Switch Assembly	20	48-66-0260	Chuck, 3-jaw (3/8-24 thread)
8	45-36-0110	Switch Spacer	21	34-80-2200	Retaining Ring
9	28-20-3141	Handle Cover	22	02-04-1060	Ball Bearing
★10	23-62-0090	Suppression System Assembly	★23	32-75-1742	Spindle Gear
★11	42-30-0060	Cord Clamp Body	24	38-50-3151	Spindle
★12	42-68-0100	Cord Clamp	25	02-50-2110	Roller Bearing
★13	22-64-0240	Cord Set	★26	43-06-0095	Grounding Disc

MISCELLANEOUS PARTS NOT SHOWN

PART NO.	DESCRIPTION OF PART	PART NO.	DESCRIPTION OF PART
06-81-0700	6-32x3/4 Fil.Hd. Cord Clamp Scs. (2)	06-81-8400	4-40x1/4 Rd.Hd. Name Plate Screws (2)
06-81-3400	6-32x1/4 Oval Hd. Cord Clamp Body Scs. (2)	06-81-5800	6-32x5/16 Fil.Hd. Switch Mtg. Sems (2)
06-81-6300	8-32x7/8 Fil. Hd. Gear Case Screw	23-86-0110	Brush Holder Insul. Washer (2)
06-81-6500	8-32x1-3/8 Fil.Hd. Gear Case Screw (2)	23-16-0050	Switch Insulator
06-65-0825	1/8x1/2 Type 5 Groove Pin	06-81-6600	8-32x1-3/4 Fil.Hd. Field Screws (2)
06-42-0800	No. 207 Woodruff Key	06-83-2670	1/4-20x1/2 Hd'less Brush Holder Set Scs. (2)
12-98-5100	Warning Plate	06-81-3700	8-32x7/8 Oval Hd. Handle Cover Scs. (4)