



SERVICE PARTS LIST

| | | | |
|--|---------|--------------------|-----------|
| SPECIFY CATALOG NO. AND SERIAL NO. WHEN ORDERING PARTS | | REVISED BULLETIN | DATE |
| 1-1/2" (40mm) ROTARY HAMMER | | 54-24-3826 | Apr. 2006 |
| CATALOG NO. | 5321-21 | WIRING INSTRUCTION | |
| STARTING SERIAL NO. | 354C | 58-01-1851 | |

See wiring instruction for terminals, connectors and end wire preparation

EXAMPLE:
 Component Parts (Small #) Are Included
 When Ordering The Assembly (Large #).

SEE BACK PAGE OF THIS BULLETIN FOR ADDITIONAL LUBRICATION AND SERVICE NOTES

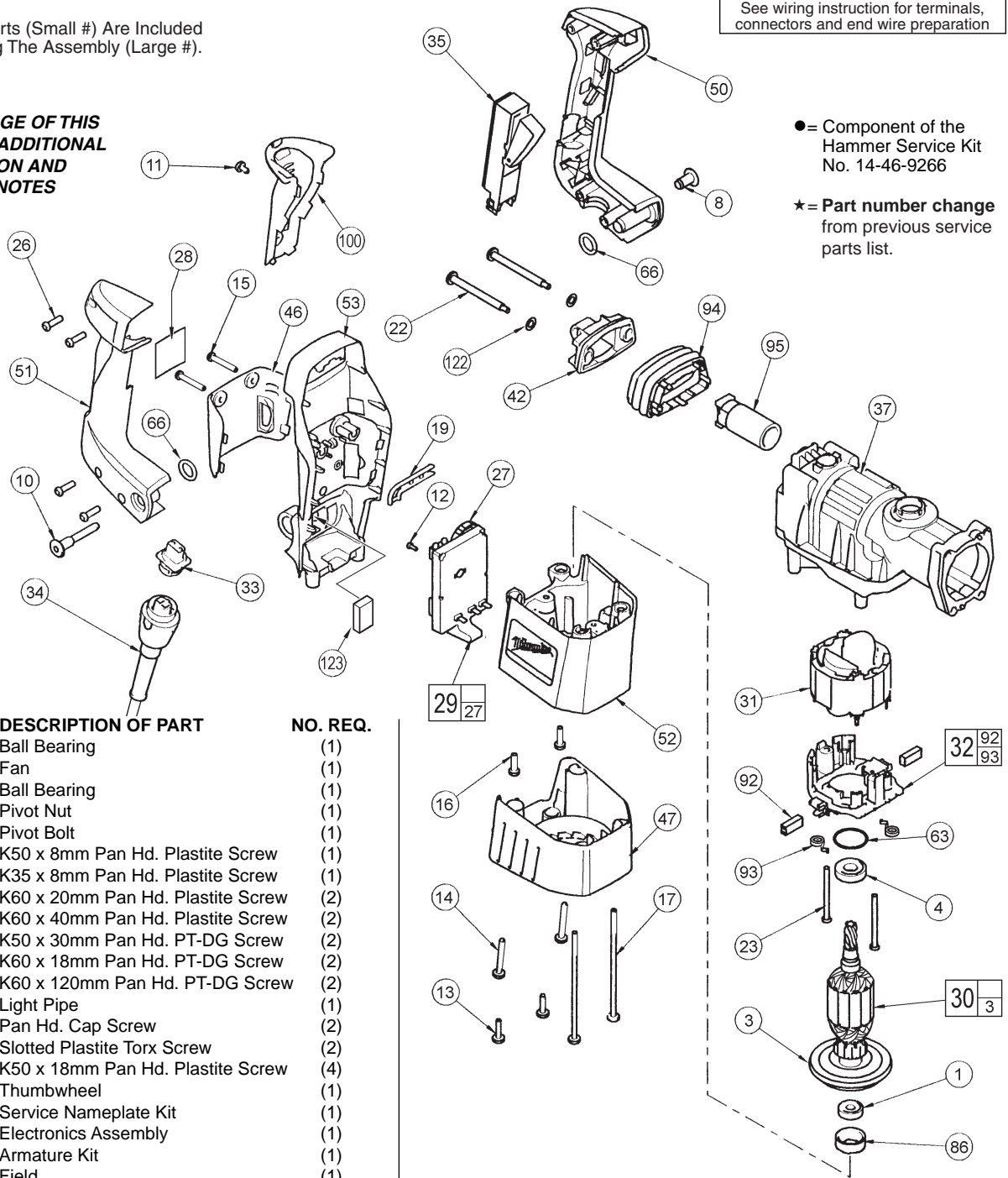

● = Component of the Hammer Service Kit No. 14-46-9266
 ★ = Part number change from previous service parts list.

| FIG. | PART NO. | DESCRIPTION OF PART | NO. REQ. |
|------|----------|--|----------|
| | 1 | 02-04-0845 Ball Bearing | (1) |
| | 3 | 22-84-0875 Fan | (1) |
| ★ | 4 | 02-04-1206 Ball Bearing | (1) |
| | 8 | 05-59-0100 Pivot Nut | (1) |
| | 10 | 05-77-0100 Pivot Bolt | (1) |
| | 11 | 05-88-3650 K50 x 8mm Pan Hd. Plastite Screw | (1) |
| | 12 | 05-88-5910 K35 x 8mm Pan Hd. Plastite Screw | (1) |
| | 13 | 05-88-5930 K60 x 20mm Pan Hd. Plastite Screw | (2) |
| | 14 | 05-88-5940 K60 x 40mm Pan Hd. Plastite Screw | (2) |
| | 15 | 05-88-9920 K50 x 30mm Pan Hd. PT-DG Screw | (2) |
| | 16 | 05-88-9930 K60 x 18mm Pan Hd. PT-DG Screw | (2) |
| | 17 | 05-88-9940 K60 x 120mm Pan Hd. PT-DG Screw | (2) |
| | 19 | 31-01-0065 Light Pipe | (1) |
| | 22 | 06-81-1805 Pan Hd. Cap Screw | (2) |
| | 23 | 06-82-7375 Slotted Plastite Torx Screw | (2) |
| | 26 | 06-95-6290 K50 x 18mm Pan Hd. Plastite Screw | (4) |
| | 27 | 31-01-0035 Thumbwheel | (1) |
| | 28 | 12-20-5315 Service Nameplate Kit | (1) |
| ★ | 29 | 14-20-1071 Electronics Assembly | (1) |
| ★ | 30 | 16-30-0642 Armature Kit | (1) |
| | 31 | 18-30-1040 Field | (1) |
| ★ | 32 | 22-22-1531 Brush Card Assembly | (1) |
| | 33 | 22-56-0042 Blade Housing Assembly | (1) |
| | 34 | 48-76-5010 Quik-Lok Cord Set | (1) |
| | 35 | 23-66-2195 Switch | (1) |
| | 37 | 28-14-2541 Crankcase Assembly | (1) |
| | 42 | 31-10-0140 Upper Handle Mount | (1) |
| | 46 | 31-15-0613 Module Cover | (1) |
| | 47 | 31-15-2053 Motor Cover | (1) |
| | 50 | 31-44-2211 Left Handle Half | (1) |
| | 51 | 31-44-2221 Right Handle Half | (1) |
| | 52 | 31-50-5101 Motor Housing | (1) |
| | 53 | 31-55-0281 Rear Shroud | (1) |
| ★ | 63 | 34-40-4215 O-Ring | (1) |
| | 66 | 34-40-4490 O-Ring | (2) |
| | 86 | 42-96-0125 ● Bearing Cup | (1) |

| FIG. | PART NO. | DESCRIPTION OF PART | NO. REQ. |
|------|----------|--|----------|
| ★ | 92 | 22-18-1353 ● Carbon Brush Kit (Includes 2 Brushes) | (1) |
| | 93 | 40-50-2220 Brush Spring | (2) |
| | 94 | 43-87-0035 Bellows | (1) |
| | 95 | 43-87-0060 Isolation Module Assembly | (1) |
| | 100 | 44-52-0590 Cushion Grip | (1) |
| | 122 | 45-88-8555 Rubber Washer | (2) |
| | 123 | 45-06-0535 Handle Seal | (1) |

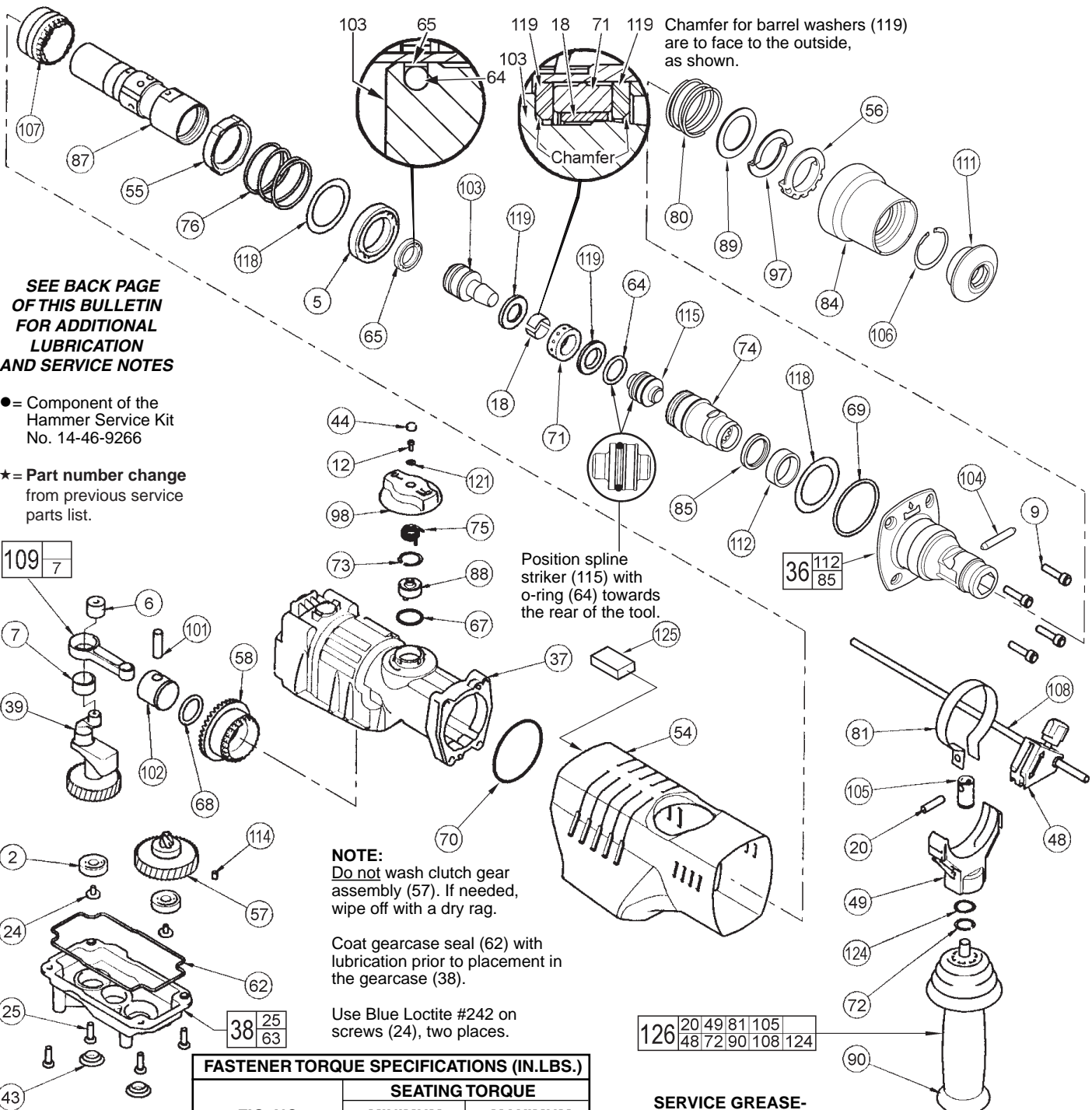

SEE BACK PAGE OF THIS BULLETIN FOR ADDITIONAL LUBRICATION AND SERVICE NOTES

● = Component of the Hammer Service Kit No. 14-46-9266

★ = Part number change from previous service parts list.

NOTE:
Do not wash clutch gear assembly (57). If needed, wipe off with a dry rag.

Coat gearcase seal (62) with lubrication prior to placement in the gearcase (38).

Use Blue Loctite #242 on screws (24), two places.

| FASTENER TORQUE SPECIFICATIONS (IN.LBS.) | | |
|--|----------------|--------------|
| FIG. NO. | SEATING TORQUE | |
| | MINIMUM | MAXIMUM |
| 9 | 120 | 140 |
| 10 | 20 | 25 |
| 11 | 3 | 6 |
| 12 | 4 | 8 |
| 13 | 20 | 25 |
| 14 | 20 | 25 |
| 15 | 15 | 20 |
| 16 | 50 | 55 |
| 17 | 30 | 35 |
| 22 | 30 | 35 |
| 23 | 12 | 17 |
| 24 | 20 | 25 |
| 25 | 45 | 50 |
| 26 | 15 | 20 |
| 74 | 130 FT. LBS. | 200 FT. LBS. |
| 87 | 130 FT. LBS. | 200 FT. LBS. |
| Switch Screws | 4 | 6 |

| | | | | |
|-----|----|----|-----|-----|
| 126 | 20 | 49 | 81 | 105 |
| | 48 | 72 | 90 | 108 |
| | | | 124 | |

SERVICE GREASE-

● "S2" Grease, No. 49-08-5265 7 oz. tube

●14-46-9266 HAMMER SERVICE KIT

THIS KIT CONTAINS:

- 2 31-12-0040 Cap Plug
- 1 34-40-0240 Gearcase Seal
- 2 34-40-4350 O-Ring
- 1 34-40-4475 Cap Seal
- 1 34-40-4215 O-Ring
- 1 34-40-4510 O-Ring
- 1 34-40-4530 O-Ring
- 1 34-40-4570 Damping Washer
- 1 42-96-0125 Bearing Cup
- 2 45-22-0680 Split Sleeve
- 1 22-18-1353 Carbon Brush Kit
- 1 49-08-5265 "S2" Grease, 7oz. Tube

● 22-18-1353 CARBON BRUSH SERVICE KIT

THIS KIT CONTAINS:

- 2 ----- Carbon Brush

| FIG. | PART NO. | DESCRIPTION OF PART | NO. REQ. |
|-------|------------|----------------------------------|----------|
| 2 | 02-04-0911 | Ball Bearing | (2) |
| 5 | 02-08-0640 | Ball Bearing | (1) |
| ★ 6 | 02-50-2755 | Needle Bearing | (1) |
| 7 | 02-50-4020 | Needle Bearing | (1) |
| 9 | 05-74-0625 | M6 Socket Head Cap Screw | (4) |
| 12 | 05-88-5910 | K35 x 8mm Pan Hd. Plastite Screw | (1) |
| 18 | 45-22-0680 | ● Split Sleeve | (2) |
| 20 | 06-65-1660 | Dowel Pin | (1) |
| 24 | 06-82-8842 | Slotted Taptite Torx Screw | (2) |
| 25 | 05-88-9910 | K50 x 22mm PT-DG Screw | (4) |
| 36 | 14-46-1980 | Spline Nose Kit | (1) |
| 37 | 28-14-2541 | Crankcase Assembly | (1) |
| 38 | 14-46-2565 | Gearcase Service Kit | (1) |
| ★ 39 | 14-09-0161 | Crankshaft Assembly | (1) |
| 43 | 31-12-0040 | ● 5/8 Cap Plug | (2) |
| 44 | 31-12-0185 | Screw Cap | (1) |
| 48 | 14-34-0551 | Depth Rod Mount Assembly | (1) |
| 49 | 31-44-2010 | Side Handle Housing | (1) |
| 54 | 31-55-0301 | Main Shroud | (1) |
| 55 | 31-58-0150 | Locking Ring | (1) |
| 56 | 31-86-0225 | Spacer | (1) |
| ★ 57 | 14-08-0211 | Clutch Gear Assembly | (1) |
| 58 | 32-30-0060 | Drive Gear | (1) |
| 62 | 34-40-0240 | ● Gearcase Seal | (1) |
| 64 | 34-40-4350 | ● O-Ring | (2) |
| 65 | 34-40-4475 | ● Capseal | (1) |
| 67 | 34-40-4500 | O-Ring | (1) |
| 68 | 34-40-4510 | ● O-Ring | (1) |
| 69 | 34-40-4520 | O-Ring | (1) |
| 70 | 34-40-4530 | ● O-Ring | (1) |
| 71 | 34-40-4570 | ● Damping Washer | (1) |
| 72 | 34-60-2580 | External Retaining Ring | (1) |
| 73 | 34-80-5010 | Retaining Ring | (1) |
| 74 | 38-50-6300 | Spline Driver | (1) |
| 75 | 40-50-0370 | Shift Spring | (1) |
| 76 | 40-50-0380 | Compression Spring | (1) |
| 80 | 40-50-0360 | Compression Spring | (1) |
| 81 | 42-16-0155 | Side Handle Band | (1) |
| 84 | 42-76-0740 | Chuck Collar | (1) |
| 85 | 45-06-0560 | Oil Seal | (1) |
| 87 | 42-98-0260 | Barrel | (1) |
| 88 | 14-14-0170 | Shift Disk Assembly | (1) |
| 89 | 45-88-1380 | Bitlock Washer | (1) |
| 90 | 14-34-0516 | Side Handle Assembly | (1) |
| 97 | 45-88-1070 | Stepped Washer | (1) |
| 98 | 14-34-0180 | Shift Knob Assembly | (1) |
| 101 | 44-60-1710 | Wrist Pin | (1) |
| 102 | 44-62-0230 | Piston | (1) |
| 103 | 44-82-0220 | Ram | (1) |
| 104 | 44-60-1640 | Bitlock Pin | (1) |
| 105 | 44-86-0620 | Band Retainer | (1) |
| 106 | 34-60-2590 | Retaining Ring | (1) |
| 107 | 44-90-0175 | Shift Ring | (1) |
| 108 | 44-94-0165 | Depth Gauge Rod | (1) |
| 109 | 44-94-0395 | Connecting Rod Assembly | (1) |
| 111 | 45-06-0040 | Dust Seal | (1) |
| 112 | 45-88-5176 | Felt Seal | (1) |
| 114 | 45-30-0060 | Retaining Slug | (1) |
| 115 | 45-56-2570 | Spline Striker | (1) |
| 118 | 45-88-1565 | Washer | (2) |
| 119 | 45-88-4005 | Barrel Washer | (2) |
| 121 | 45-88-7170 | Washer | (1) |
| 124 | 45-88-8730 | Wave Washer | (1) |
| ★ 125 | 44-52-0041 | Breather Pad | (1) |
| 126 | 14-34-0585 | Side Handle Assembly Kit | (1) |

NOTE: Check the clutch torque. Clutch must slip at 40 to 50 ft.lbs. at the spindle, checked clockwise as viewed from the front of the tool.

SEE BACK PAGE OF THIS BULLETIN FOR ADDITIONAL LUBRICATION AND SERVICE NOTES

Press Needle Bearing (7) in Connecting Rod (109) so that the same amount sticks out on both sides of the Rod.

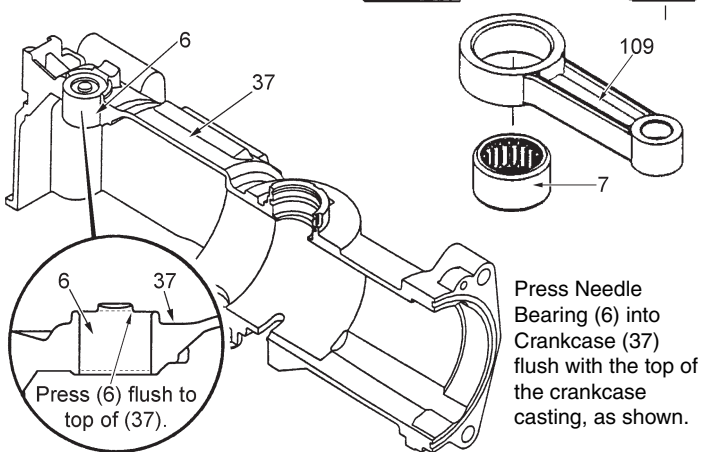

LUBRICATION NOTES: (TYPE "S2" GREASE, NO. 49-08-5265)

Fill Piston (102) with "S2" grease and assemble to Connecting Rod (109) with the Wrist Pin (101). Front surface of Piston (102) and the Ram (103) is to be free of grease.

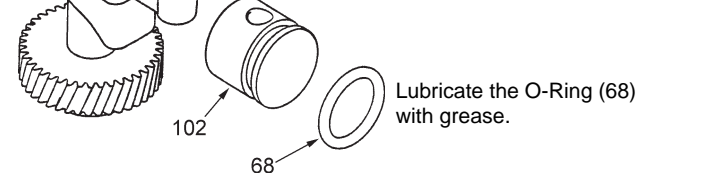

Lightly coat the inside of the Barrel (87) with grease prior to assembly.

Lightly coat the inside bore and the press fit area of the Spline Driver (74) prior to the insertion of the Striker (115).



Fill cavity of Crankcase (37) with 5.5 oz. of grease.

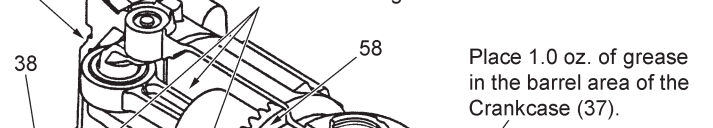

Apply a light coat of grease to the Drive Gear (58) prior to assembly.

Prior to assembly, apply a light coat of grease to the Gearcase Seal (62) and O-Rings (63, 64, 67, 68 and 70).

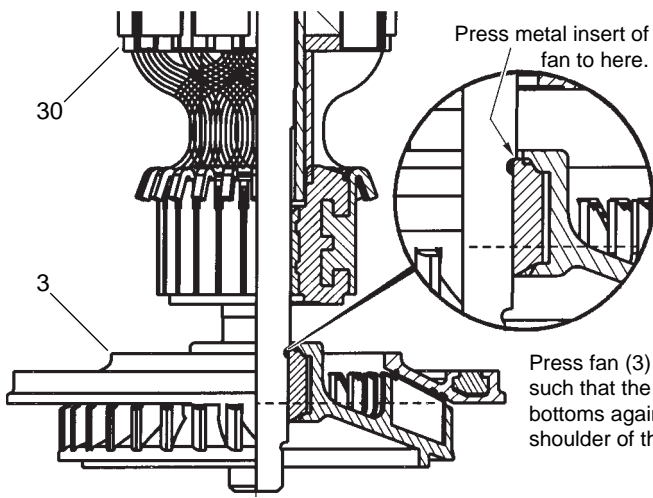

Press metal insert of fan to here.

Press fan (3) onto armature (30) such that the metal insert of the fan bottoms against the fan journal shoulder of the armature shaft.

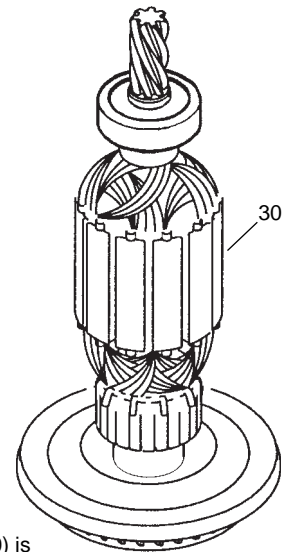

After the armature assembly (30) is installed into the tool, the bearing cup (86) is to be placed on the rear armature bearing (1), (already pressed onto the armature shaft), prior to assembling the motor cover (47) to the tool.

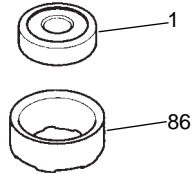

NOTE: Do not dislodge the bearing cup from the bearing during assembly.

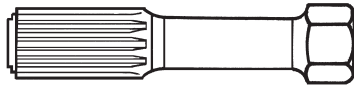

61-10-2065 Spline Shank



3/4" [19mm] Hex

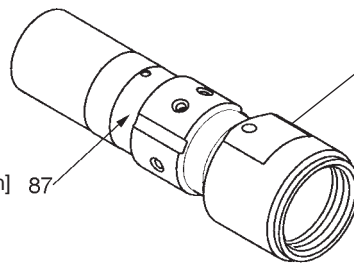

Barrel

when tightened in a vise, **extra care** should be taken not allowing the barrel to turn and mar or burr its finished cylindrical surface.

no loctite® is required on threads of spline driver or barrel.

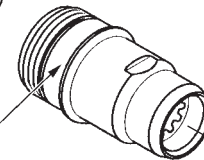

Spline Driver

torque to 130-160 ft-lbs. [176-217 Newton-meters]

BARREL / SPLINE DRIVER SERVICING-

To aid in the servicing of the Barrel and Spline Driver of the 5321-21 Spline Drive Rotary Hammer, a Service Tool No. 61-10-2065 has been developed [see illustrations].

- clamp the flats of the Barrel in a vise.
- use a 3/4" [19mm] socket on the hex of Service Tool to either remove [turning counter-clockwise] or install [turning clockwise] the Spline Driver.

SERVICE NOTE:
SLIP CLUTCH VALUES

When servicing this Spline Drive Rotary Hammer, the static torque required to slip the clutch mechanism should be checked. It must not exceed the maximum value shown below:

- block armature from rotating.
- using service tool and ft-lb [newton-meter] torque wrench with 3/4" [19mm] socket, check the static torque required to slip the Spline Driver / Clutch Mechanism of the Rotary Hammer.
- **the torque for the 5321-21 should be 40-50 ft-lb. [52-68 Nm].**